

Technical Specification for Talla Shomhairle

at The Aros Centre, Viewfield Road, Portree, Isle of Skye, IV51 9EU.



Admin :
Telephone 01478 613649
ruairidh@aros.co.uk

Box Office :
01478 613750
bookings@aros.co.uk

Stage

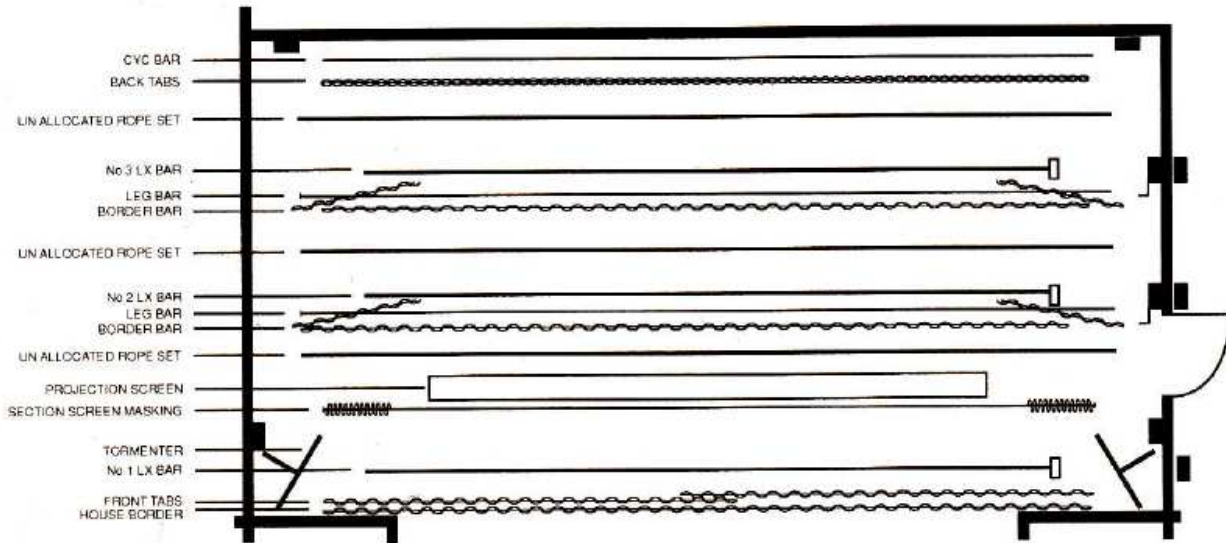

Proscenium arch with stage performing area: 10m x 5.5m. Height from stage floor to rolled cinema screen: 5m.

Floor : sprung wood, heated and suitable for all dance.

Thrust : Prolite Stagedeck 1.5m across 8m between ground floor balconies.

Dance surface : Harlequin reversible, 8 rolls.

Access SR & SL with backstage crossover.

Motorised FOH tabs, controlled either from SL or control room

Motorised masking tabs half way upstage, controlled from control room

6m x 2.6m motorised cinema screen

3 x wired lighting bars with selection of lamps

2 x side lighting bars stage left and right.

Stage manager's desk with cue lights, intercom, backstage and FOH paging & show timer

Intercom system to control room sound & lighting points + other areas

13 amp, 32 amp (SL) and 64 amp (SL) outlet sockets

7 x suspended bars on pulley system to allow for installation of drapes, scenery etc

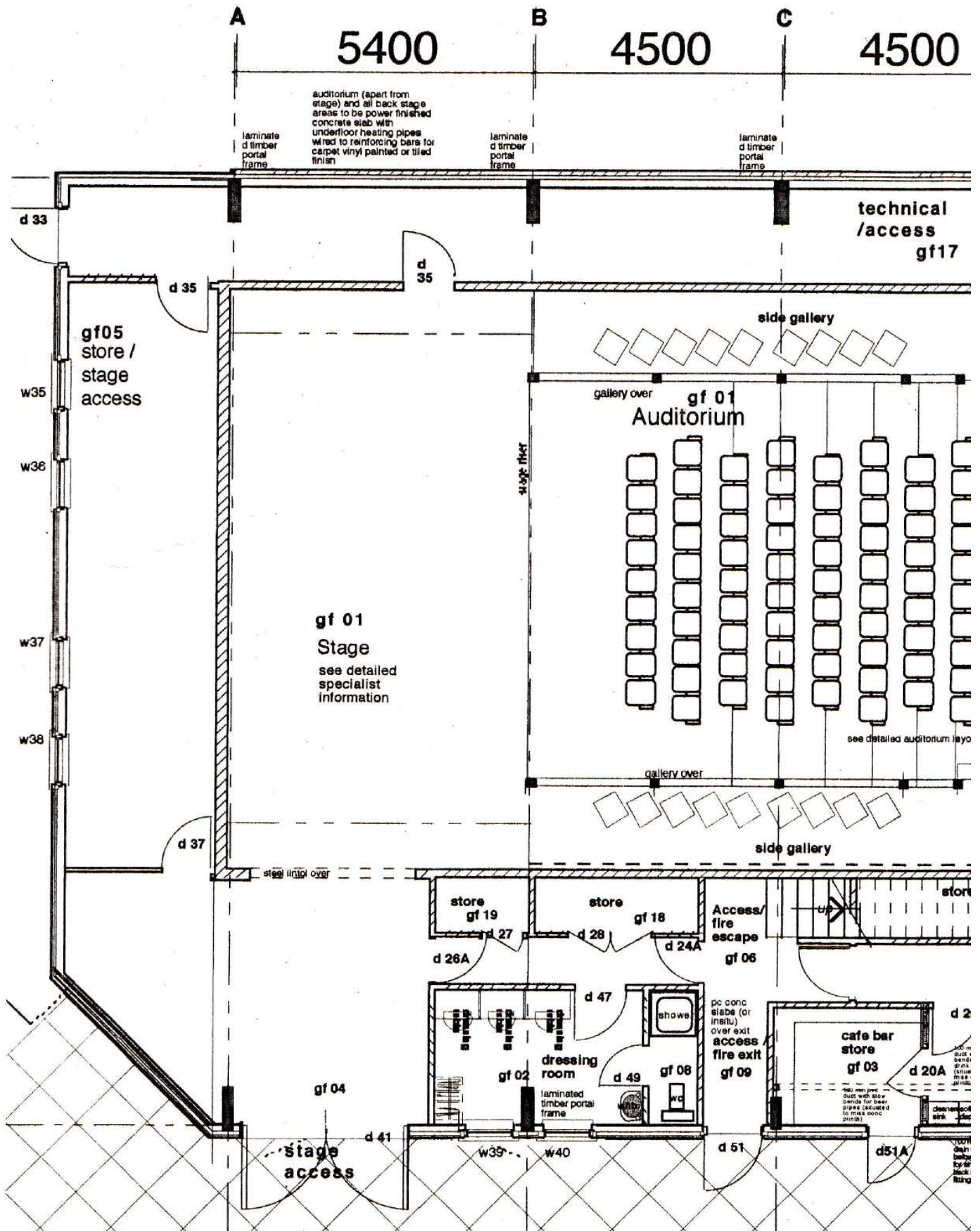

Technical Gallery (SL)

Pulley systems for all stage bars including lighting and scenery bars, and plugs for lighting

Sound

Stage Boxes

24	fixed XLRs to mixer mic inputs (1-24)
8	snake XLRs to mixer mic inputs (25-32)
4	fixed XLR returns
4	snake XLR returns

Main board : A&H Qu32, with wireless network control (QuPad, QuYou etc). Board and network both password secured.

Backup board : Soundcraft Live 24 (24:4:8)

FOH :

2	Martin EM76A (<i>permanently rigged</i>)
2	Martin EM76A (<i>optional</i>)
2	Martin EM201 Subs

Zoom RFX-2000 digital reverb with multi effects.

Phonic 31 band dual digital graphic equaliser for FOH mix

Monitors :

2	T & M 122
2	Martin EM56

2 x Yamaha graphic equaliser for monitor mix

All amplifiers are Yamaha P3500, except for close monitoring in control room, which is Alesis and the T & M SA 800 mentioned above.

T & M SA 800 power amplifier

Induction loop for the hard of hearing in the auditorium.

Ampetronic ILD 500 Induction Loop amplifier.

1 x Tascam DA 30 DAT machine

1 x Fostex D5 DAT machine

1 x Denon Minidisk machine

1 x Denon CD player

1 x Denon Cassette machine

2 x Tascam Da 38 8 track Multitrack machines

1 x Panasonic S-VHS Video Machine

1 x Goodmans DVD player

1 x Pace motorised satellite system receiver

Patchbays allowing a wide range of configurations of system

Selection of microphones:

5	Shure SM57 Beta
4	Shure SM58
4	Shure SM58 Beta;
2	AKG C1000S;
1	Audio-Technica AT 4033;
2	Beyer M88TG;
2	Beyer M201TG,
2	Sennheiser MD504,
4	Shure handheld wireless;

Selection of microphone stands incl. straight, boom and short boom

2 x EMO passive DI boxes and 3 x Behringer active Ultra DI plus all necessary leads and connectors

Lighting

Strand GSX desk with Genius 50, Kaleidoscope and Communiqué options

Selection of lanterns: 6 x Cantatas 11/26; 8 x Quartet 22/40; 16 x Quartet F with Barn Door attachments; 10 x Par Cans; 4 x Coda 500/4

House system configured as follows:

2 x 9m 12 way bars on winch sets located on the stage with selection of lanterns

1 x 9m 4 way bar on winch set located on the stage with cyclorama lanterns

2 x side lighting bars stage left and right

8 x dips SL and SR

1 x continuous 24 way FOH lighting bar wired on 12 circuits with selection of lanterns

2 x follow-spot positions

Spare capacity for companies wishing to use their own lights

2 x portable stands for lighting

Selection of filter gels

Projection

2K Digital Cinema Projector NEC 1200C, Dolby Server DSS220, Dolby Surround Sound Processor CP 750, Dolby 702 Digital Sound Head, Allen and Heath iDR4 Digital Sound Processor.

F.O.H. video projector (throw 14 m to screen).

Seating

181 fixed seats, of which 12 restricted view behind pillars

raked seat fully air conditioned auditorium, with 4 wheelchair points

Other facilities

1 star dressing room with 3 lit mirror spaces, washbasin, private toilet and shower

2 dressing rooms with 2 mirrors in each room

150 seat restaurant

Cafe-bar area

Disabled access throughout the building, including all backstage areas